



SWEDISH INNOVATION, QUALITY & DESIGN

En

# Granule Flexi®



**GRANULDISK®**

Effective in its flexibility



# GRANULE FLEXI®

Granule Flexi® is a front loaded No Pre-Washing™ pot washer which caters for the varying needs of small and medium-sized kitchens. Granule Flexi is a versatile, compact and efficient solution and is ideal for both à la carte kitchens with mixed pot washing and for the pure Gastronom kitchen - it all comes down to which edition you choose.

GRANULE FLEXI® INCORPORATES THE INNOVATIVE GRANULE TECHNOLOGY™ AND ELIMINATES THE NEED TO PRE-WASH.



#### LESS CHEMICALS.

Saves up to 2.2 litres per day  
- up to 660 litres per year



#### LESS WATER.

The ECO programme saves up to  
1,100 litres per day and up to  
330 000 litres per year



#### LESS ENERGY.

Saves up to 37,6 kWh per day  
- up to 11,280 kWh per year



#### LESS TIME.

Pre-washing eliminated means  
clean pots and pans in 2.5 minutes



#### HIGH CAPACITY.

4 GN1/1 per programme  
- up to 96 GN1/1 or 192 GN1/2  
per hour

(max. depth 200 mm)



#### FOOD SAFETY.

All wash programs comply with  
the hygiene guidelines of the  
DIN 10512 standard



#### USER-FRIENDLY DESIGN.

Eye-level control panel.  
Large buttons and clear symbols.  
Reminders and messages on the display.  
Multi-level and grip-friendly handle.  
Red and green indicator lamps.  
USB port for export of HACCP log files.

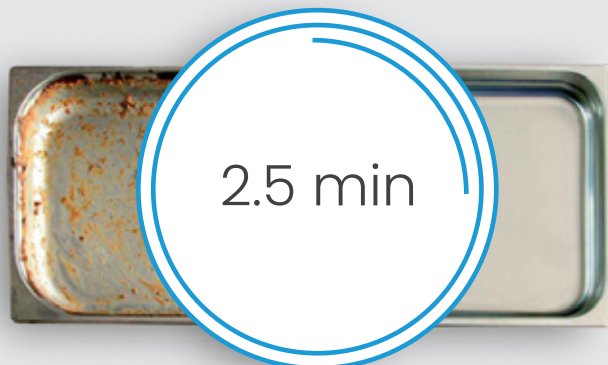

power  
**GRANULES®** BIO

*The savings above are based on a sample site preparing 400 meals per day and 300 operational days per year. The comparison features manual washing in sinks compared to Granule Flexi ECO cycle.*

# AVAILABLE IN TWO EDITIONS.

Granule Flexi® is available in two different editions: *Flexible* and *Gastronorm*. Each edition comes with carefully selected standard accessories and can be further customised to your needs by adding one or more smart accessories.

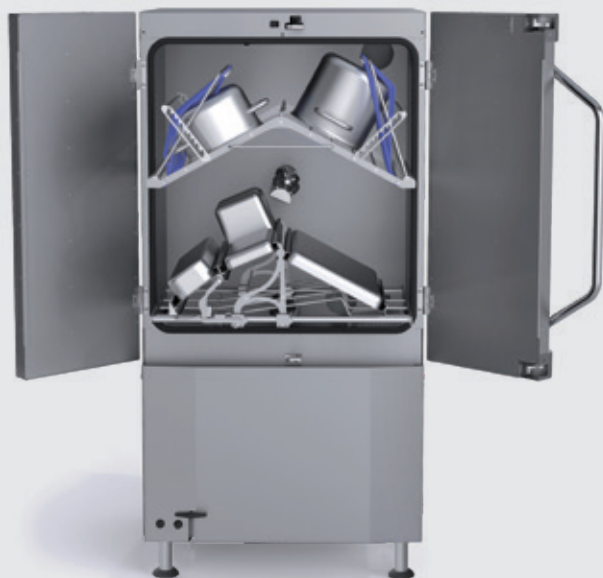

## GRANULE FLEXI® - FLEXIBLE EDITION.

Art no. 20715

Granule Flexi Flexible Edition fits the kitchen utensil setup in an à la carte kitchen that needs to wash a wide range of pots, pans, skillets, bowls and utensils.

Enables washing on two levels. The lower rack can be modified to load 2/1 sheets or large, deep pots (max. 700 mm deep, Ø 500 mm – requires additional *Short Spraypipe* accessory) and the top rack can load a range of miscellaneous washware from the à la carte kitchen.



## GRANULE FLEXI® - GASTRONORM EDITION.

Art no. 20716

Granule Flexi Gastronorm Edition fits kitchens that work mostly with a Gastronorm setup of pans and containers.

Enables washing on two levels. The lower rack can be modified to load 2/1 sheets or large, deep pots (max. 700 mm deep, Ø 500 mm – requires additional *Short Spraypipe* accessory). The top rack loads GN1/1-1/9, max. 200 mm depth or GN2/1, max. 200 mm depth.

### WASH IT LIVE!

Want to see Granule Flexi® in action?  
Visit a Live Wash™ - read more at

[www.granuldisk.com/livewash](http://www.granuldisk.com/livewash)



# ACCESSORIES.

Granule Flexi® Editions can be further customised to your unique needs by adding one or more smart accessories and inserts.

## FIXED INSERT FOR GN CONTAINERS.

Art no. 13465

To fit GN1/1-1/9 up to a depth of 200 mm. Capacity 2 GN1/1 up to a depth of 200 mm or equivalent in small GN containers.

*(Included in Gastronorm Edition.)*

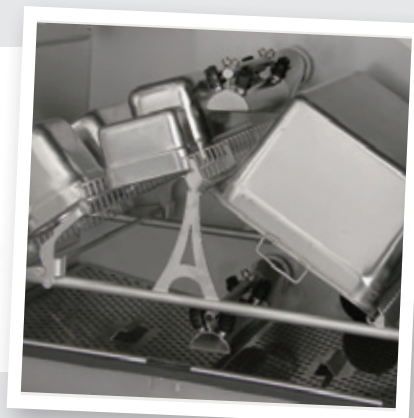
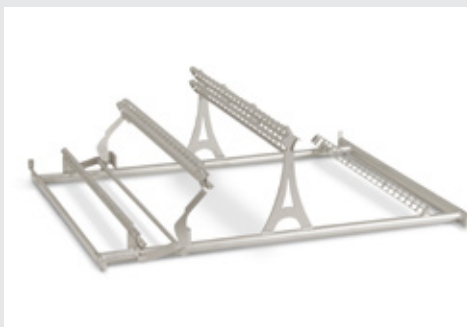

## FLEXIBLE INSERT FOR GN CONTAINERS AND MIXED WASHWARE.

Art no. 14454

To fit GN containers, bowls, saucepans, sieves, etc, incl. 1 spare rubberband. Capacity: 2 GN1/1 up to a depth of 200 mm or a mix of utensils.

*(Included in Flexible Edition.)*



## ADJUSTABLE INSERT FOR GN CONTAINERS AND POTS.

Art no. 13463

Capacity: 2 GN1/1 up to a depth of 200 mm or 1 GN2/1 or 1-3 pots.

*(Included in Flexible and Gastronorm Edition.)*



## SHORT SPRAY PIPE.

Art no. 26828

Replaces long spray pipe to allow washing of pots up to a depth of 700 mm.

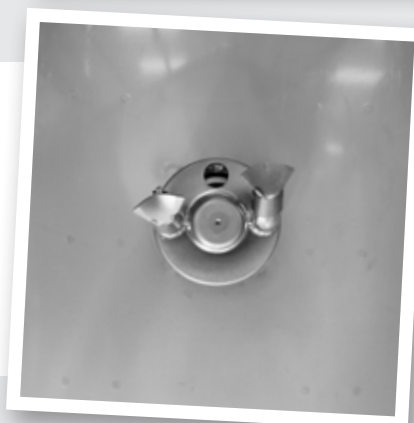



## INSERT FOR LARGE TRAYS (NON-GN SIZE).

Art no. 13736

Capacity: 8 sheet pans 655 x 450 mm,  
with 25 mm edge or 8 large trays 690  
x 450 mm, with 22 mm edge.

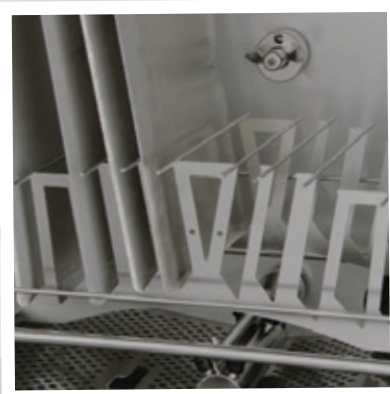

## INSERT FOR BAKING SHEETS.

Art no. 13744

600 x 400 mm, with 20 mm edge.  
Capacity: 8 pcs



## NET BASKET WITH LID.

Art no. 21477

For ladles, whisks up to 500 mm in  
length.



## HOLDER FOR STORAGE OF ACCESSORIES.

Art no. 6001159

To store inserts and accessories not  
in use. Hangs at either side of the  
machine.

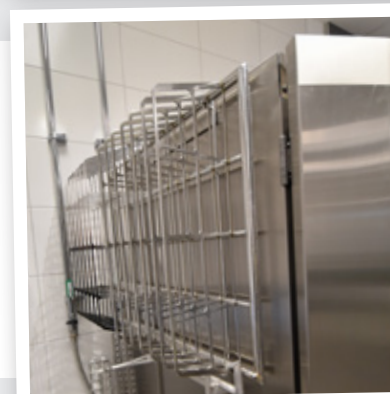

## INSERT FOR LIDS AND TRAYS (GN SIZE).

Art no. 6001147

To fit slightly soiled GN-sized flat trays  
or lids. Capacity: 12 pcs.

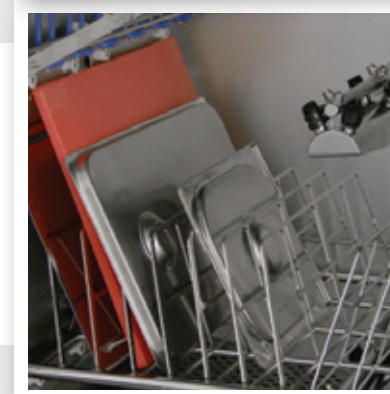
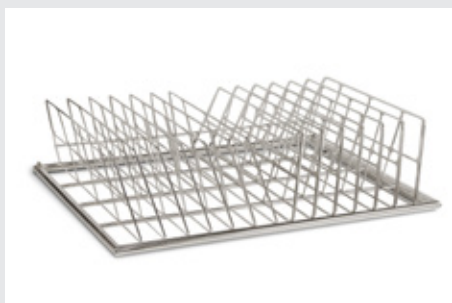





# GRANULE FLEXI® TECHNICAL DATA.

## GENERAL.

Design	Front loaded with two level washing
Outer dimensions (H x W x D)	1775 (±25) x 870 x 1017 mm
Loading volume	205 litres (H 650 x W 600 x D 530 mm)
Weight (filled / empty)	369 kg / 275 kg
Wash tank volume	84 litres
Rinse water volume	4 litres (ECO programme) 8 litres (Short / Normal programme) <i>To achieve 3,600 HUE in accordance with NSF/ANSI 3, 8 litres is necessary.</i>
Granule volume	6 litres
Wash temperature	65 °C
Rinse temperature	85 °C
Sound pressure level	< 70 dB (A)

## PROGRAMMES & CAPACITY.

Wash programmes with Granules	ECO: 2 min, 30 sec Short: 4 min, 40 sec Normal: 6 min, 40 sec
Wash programmes without Granules	ECO: 2 min, 30 sec Short: 3 min, 40 sec Normal: 5 min, 40 sec
Max. / normal capacity per hour (normal capacity incl. handling)	96 / 84 GN1/1 or similar in other pots
Capacity per programme	4 GN1/1 or 8 GN1/2 or 1x GN2/1 + 2x GN1/1, max. 200 mm depth, or similar in other pots.

## ELECTRICAL CONNECTION.

Voltage**	3~ 400/415 V/50 Hz + PE / 3~ 230 V/50 Hz + PE / 3~ 380 V/50 Hz + PE
Fuses (at max output 12.0 kW)	25 A (400/415 V, 380 V) / 40 A (230 V)
Fuses (at max output 17.0 kW)	32 A (400/415 V, 380 V)
Max output, hot fill	12.0 kW
Max output, cold fill	17.0 kW
Wash pump motor	2.2 kW
Rinse pump motor	0.37 kW
Heater wash tank*	9 kW at output 12.0 kW (14 kW at output 17.0 kW)
Heater rinse tank*	9 kW at output 12.0 kW (14 kW at output 17.0 kW)
Enclosure rating	IPX5

## WATER CONNECTION.

Hardness / Connection	Total hardness: 3-7 °dH, 5-12 °TH, 53-125 PPM / ¾" BSP male (DN20) <i>Note: reverse osmosis/distilled water must not be used</i>
Connection A	12.0 kW unit: 1-6 bar, 15 l/min, 55-65 °C (Hot fill) 17.0 kW unit: 1-6 bar, 15 l/min, 5-65 °C (Cold fill, optional)
Connection B	12.0/17.0 kW unit: 3-6 bar, 15 l/min, < 20 °C

## DRAIN & VENTILATION.

Ventilation with steam reduction	150 m³/h
Ventilation without steam reduction	400 m³/h
Ventilation recommendation with EcoExchanger	75 m³/h
Heat emitted to room with steam reduction (total/sensible/latent)	1.2 kW / 0.5 kW / 0.7 kW
Heat emitted to room without steam reduction (total/sensible/latent)	1.7 kW / 0.5 kW / 1.2 kW
Heat emitted to room with EcoExchanger (total/sensible/latent)	0.9 kW / 0.5 kW / 0.4 kW
Drainage pipe	Pipe Ø 32 mm
Drain	Capacity requirement 50 l/min. No drain pump, gravity drain. <i>The machine must not be placed directly over a drain.</i>
Detergent and rinse aid	Required. 230 VAC signal is available from a separate box. Max load total 0.5 A.



## VOLTAGE OPTIONS.

Cannot find your special requirements in the list? All GRANULDISK pot washers are built to order and can often be customised to fit specific voltage and water conditions.

What are your needs?

Talk to your GRANULDISK sales representative or preferred Certified GRANULDISK Sales Partner for more information about customisations.



## STEAM REDUCTION OR ECOEXCHANGER® ?

With the add-on *steam reduction* to your Granule Flexi® you ensure a more pleasant working environment for staff and lower the ventilation requirements. Adds 70 seconds to the total time of the wash program.

The add-on EcoExchanger® cleverly combines steam reduction and heat recovery in one and improves the working environment while also reducing the energy needed for heating the wash tank by up to 35%. Adds 80 seconds to the total time of the wash program.

Talk to your GRANULDISK sales representative or your preferred Certified GRANULDISK Sales Partner for more information about steam reduction and EcoExchanger® for Granule Flexi®.



\* Never operate simultaneously.

\*\* For all available voltage options, please turn to your sales representative or consult a valid pricelist.

Granule Flexi® is supplied with a 2-metre-long power cable (without plug) for connection to an approved mains switch. The mains switch is not included in the delivery.

# GRANULE FLEXI® INSTALLATION.

(A/B) Water inlet. (C) Drain. (D) Detergent/drying agent connection. (E) Electrical connection. (F) USB port.

See previous page for details.

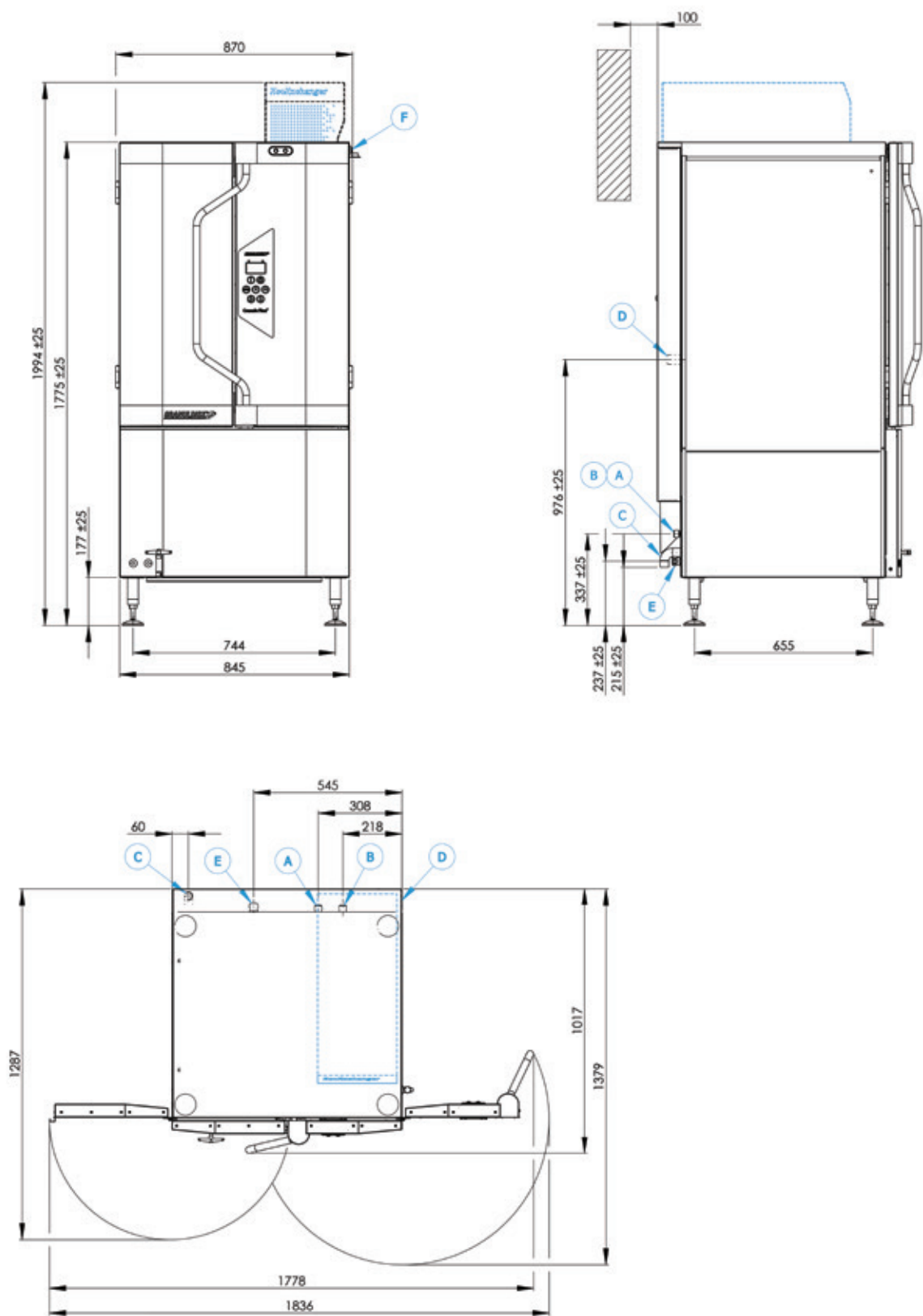

(mm)